

Annual Report 2022-23





Oriental hornet (*Vespa orientalis*)

Contents

1. OUR TEAM
2. FOUNDER'S MESSAGE
3. ABOUT GREEN YATRA
4. IMPACT
5. PROJECTS
6. FINANCIALS
7. MEDIA
8. PARTNERS



Siberian Stonechat (Saxicola maurus)

Our Team

Directors



Pradeep Tripathi
Founder
Dendrophile & Tink tank



Durgesh Gupta
Founder
Legal, Operations & Finance



Anjana Kaura
Director
Think tank & Strategy.



Nidhi Sharma
Director
Sustainability & Climate Edu



Ambika Gandotra
Director
Corporate Relations

Middle Management



Siddharth Ingle
Botanist & Ecologist



Manoj Pradhan
Grant & Mangrove expert



Prashant Aagle
Community & Livelihood



Madhavi Bhalekar
Mangrove Expert

Field Team



Bhavesh Jogadiya
Civil & Project Management



Raj Dwivedi
Operation & Execution



Atish Wawre
Civil & Project Management



Clive Dcosta
Ecologist & Biologist



Prathmesh Kesarkar
Botanist



Rushabh Chaudhary
Botanist



Alok Pandey
Water Expert



Kishore Nadar
Zoologist & Botanist



Chetan Rathod
Field Coordinator

Office Team



Sandra Pereira
Ornithologist & Botanist

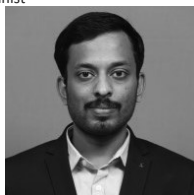

Anmol Valiyare
Research



Abhishek Anand
Communication & Research



Jehu Nadar
Social Media



Kamini Godade
Architect

Founder's Message

The past year has truly been a challenge for all, and as Green Yatra stepped into its fourteenth year, we wish to spread greenery, fresh air, positivity & hope on this planet.

We began this journey with a dream of green and sustainable world for all and turned it into an ecosystem of environmental change. Today, we have successfully created a community of nature enthusiasts who work tirelessly to conserve and protect our earth. Since our inception, we have touched millions of lives positively, conserve and protected over millions of trees planted more than 13,00,000 trees, empowered 200,000 families, offset more than 500 KWh of energy and cleaned 2,200,000 KL of water. We aim to achieve the 'Sustainable Development Goals 2030' through our carbon neutral initiatives and believe in focusing on the solution rather than the problem which has prompted our dedicated team to perpetually work towards innovation & creativity in all spheres of the environmental sector. Because planting trees and rejuvenating water bodies isn't enough to mitigate climate change, therefore we have introduced new projects such as Sustainable Solutions through which we calculate waste, water, energy & transport footprint and curate simple & sustainable solutions to curb

carbon emissions at the source. In the past year we have expanded our horizons towards coastal mangrove ecosystems. Mangrove forests across



Pradeep Tripathi Founder of Green Yatra

coastal areas of India are extremely important in terms of providing protection to the coast from erosion, tides and cyclones. Not only that, mangrove forests are biodiversity hotspots which provides shelter to many terrestrial as well as aquatic life and also acts as a source of livelihood for all the human settlements that reside in its vicinity. Our new project for Mangrove Restoration and Rejuvenation which is known as *Blue Yatra* uses innovative techniques and biomimicry to effectively restore or rejuvenate mangroves across wetlands. We have started our journey of Mangrove restoration from coastal area of Mumbai and Navi Mumbai and would soon expand our operations into other coastal regions of India as well.

Even though our projects can be effective to fight climate change, for us to see a substantial change in our current situation, a larger portion of the humanity makes a conscious effort to

■ ■ ■ Founder's Message

change as well. I believe this could only happen when we spread awareness across households, schools, colleges and corporates so that the progress that we make towards a sustainable future is not an isolated or a temporary instance. We have designed our Climate Education program to implement this very vision in the real world. Our team has made remarkable progress in spreading awareness by bringing the public on board to our mission to fight climate change through interactive workshops and webinars.

Green Campus Programme is an allied initiative that we have started along with Climate Education which focuses on schools and colleges. Our primary objective under this programme is to transform Schools and Colleges across India to become more sustainable and provide less privileged students the best infrastructure and guidance for them to be ready for their future. Through retrofitting school and college campuses with more sustainable and efficient systems as well as providing necessary training and guidance to students we are planning to develop ideal campuses which would match international standards. I believe that the fate of humanity in the long run rests in the hands of our future generation and its our responsibility to train and provide the

best facilities for them to develop and grow.

We are grateful to be living our dream of serving the environment but, time is of the essence here, we cannot afford to waste more resources. With only seven years to rectify decades of damage, our actions matter now. We continue our appeal in encouraging everyone to work honestly towards the protection and conservation of Mother Nature.

About Green Yatra

Green Yatra is a leading environmental Solutions NGO founded in 2008, with a Nature Centric Approach, working Pan India on a dedicated journey towards the protection and conservation of environment and biodiversity. Our expertise lies in helping organizations achieve the UN SDG 2030 and Carbon Neutrality through our customized programs that provide a one-stop solution; right from assessing their carbon footprint to providing the solutions to offset it. We offer the flexibility to customize solutions as per your organization's objectives and policies.

We believe in finding new ways to protect our nature apart from doing traditional way of nature plantation. We started this year with Mangrove plantation in coastal areas to preserve our water ecosystem from degrading .

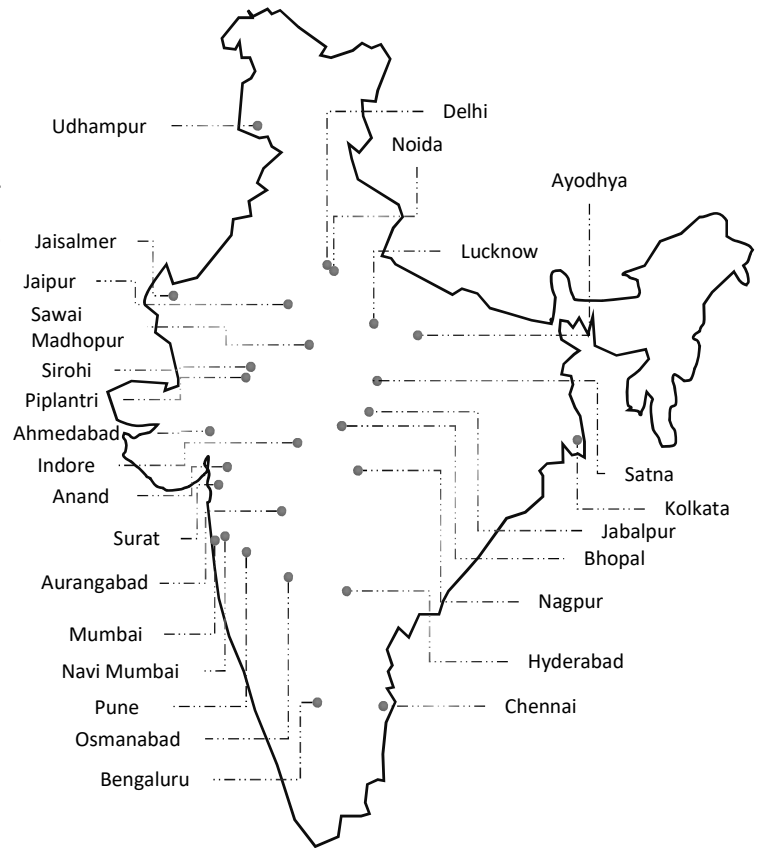

Presence: Our Presence across India

Meet Our Team: Green Yatra Team at plantation site.



Biodiversity Park & Nature Interaction Centre



Impact



13 Lakh+ 
Saplings planted

5+ 
Nature interaction centers
& Native biodiversity parks

220+ cr 
Liters of water conserved

1,000 + 
People educated in
sustainability

30,000 + days 
Equivalent employment
generated

 60+
Miyawaki forest created

 25,000+
Volunteer participation

 25+
Water body restored

 500 +
Partners collaboration

Building a greener future: Plantation site in Nis Navi Mumbai.

Since our inception, we planted more than 13 lakh saplings pan India. We are making an active effort to increase green cover of the country and provide urban people the ability to breathe clean air and lead a healthy lifestyle. Apart from tree plantation, we have also carried out other important projects such as water body restoration of lakes and ponds across India. Until now, we have restored more than 25 lakes and ponds majorly in Bangalore, Mumbai, Delhi, Thane,. We have partnered with more than 500 companies, government bodies and other institutions for our projects. We have also conducted various volunteering events and workshops for the local people which have been able to attract more

than 25,000 volunteers. We have also conducting carbon auditing for organizations to help them reduce and mitigate their carbon emissions. Our work covers **14 out of 17** SDG goals.

"The greatest threat to our planet is the belief that someone else will save it."

- Robert Swan

Currently, we are working pan India with our team presence in Mumbai, Delhi, Hyderabad, Nagpur, Ayodhya, Indore, Bhopal, Jaipur, Kolkata, Chennai, Lucknow, Guwahati, Patna, Aurangabad, Gurgaon, Noida, Ghaziabad and many more cities.

Projects

Biodiversity Park & Nature Interaction Centre

As the human population grows, their needs must also be fulfilled. To meet their ever-growing demands, forests are being exploited. This affects the biodiversity of an area. From microorganisms present in the soil to the birds in the sky, we need them for our survival and the stability of our ecosystem. To compensate for that loss, we have started developing biodiversity park in cities that will have multiple benefits for the nature, people and the biodiversity. This will help to restore and become shelter for various living organisms.

'Biodiversity parks are a great way to connect people with nature and to teach them about the importance of conservation.'

Currently, we have five ongoing projects where our sole focus is to transform the

In Development: Our Amarpur Biodiversity Park in collaboration with HCL Foundation, Greater Noida Delhi NCR.



area into a place where native biodiversity is restored and the public could learn more about nature through these parks. We incorporate a variety of public amenities such as sensory gardens, tree banks, cultural groves, butterfly gardens, and many more in our biodiversity park. Through this project, we want to bring the public and nature closer together. Our biodiversity parks are built with the aim of becoming a place where people can fall in love with nature.

Impact of a biodiversity park



Provides protection to local biodiversity

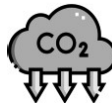

Acts as an excellent carbon sink



Excellent place for recreation



Improves public health



Helps to educate the importance of biodiversity to the public



Provides a place of reference for researchers

Projects

Sahyadri Biodiversity Park, PCMC Pune

As site is in the Pune, cultural capital of Maharashtra and surround by Sahyadri Range of Forest, keeping both factors in the mind we are developing it into a biodiversity park based on in theme of Indian Culture and Heritage. It is a 20 acre site located near MIDC Bhosari where we have carried out extensive landscaping and plantation in collaboration with **Pimpri-Chinchwad Municipal Corporation** and would be completed by next year.

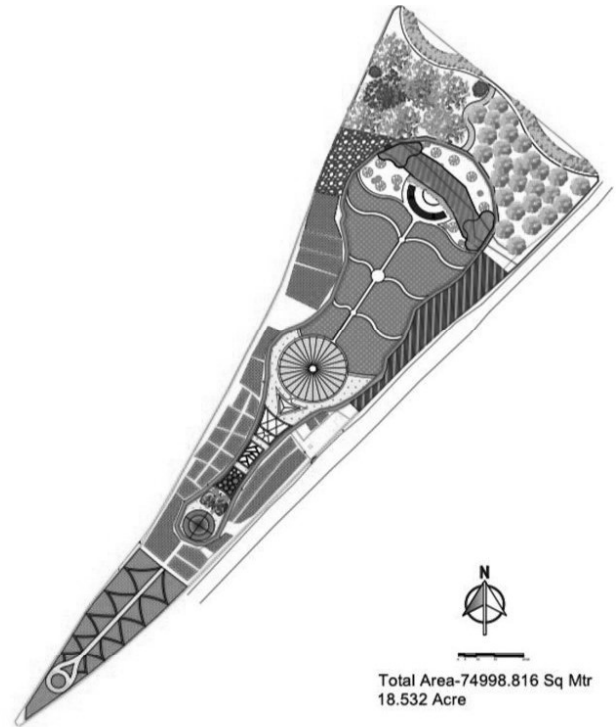

Total Area-74998.816 Sq Mtr
18.532 Acre

Condition before intervention

- Degraded soil
- Low biodiversity
- Area infested by invasive plant species
- High levels of pollution in the locality

Proposed Design: Thematic map design of the biodiversity park Gavali Udyan, Pune.

Proposed Design: Thematic map design of the biodiversity park Nisarg Udyan, Navi Mumbai.

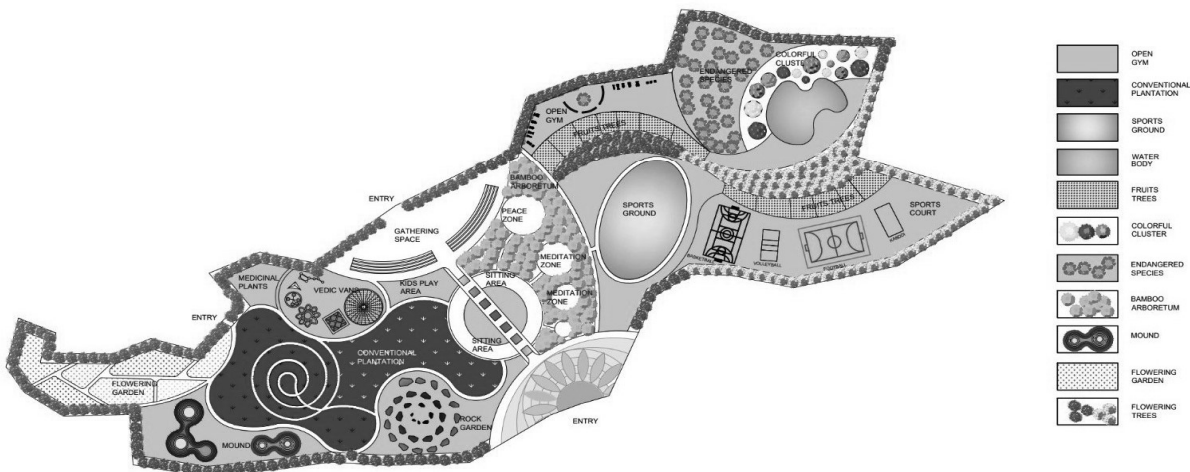



Before

What it looked like: The site area of Gavali Udyan, Pune before intervention.



After

Current Situation: Progress done as of now in Gavali Udyan, Pune

Projects

Nisarg Udyan Miyawaki Biodiversity Park, Navi Mumbai

We are trying to create the world's first man-made biomimic of a biodiversity hotspot (the Coastal Western Ghats) through an endemic species restoration project in the heart of a mega city using innovative methods. This project will also provide roosting and nesting habitat for flamingos. This biodiversity park will make use of all natural elements and result in creating a biodiversity-rich, forest-like landscape that will function as a bird habitat for both migratory and local birds.

This project is the ecological restoration of an old dumping yard. The project is exclusively funded by our CSR partner **Sony Music** which is been carried out in 3 phases. Phase 1 & 2 work is completed with 60,000+ and 40,000+ saplings planted, respectively. The biodiversity park would be developed in Phase 3. Along with the aforementioned attributes, we are also planning to create

In the making: Transforming dumping yard into a biodiversity park, Navi Mumbai



a separate section known as “Tree Bank”. Where we would nurture and conserve rare and endangered endemic plant species of the Western Ghats that have been threatened due to increasing anthropogenic activities. This section will be open to the public as well as researchers to view and learn more about the plant species.

The Tree Bank will also serve as a seed bank and propagation center for these plants, helping to ensure their long-term survival and reintroduction into the wild.

Quick Glimpse : Visual representation of how our biodiversity parks would look like

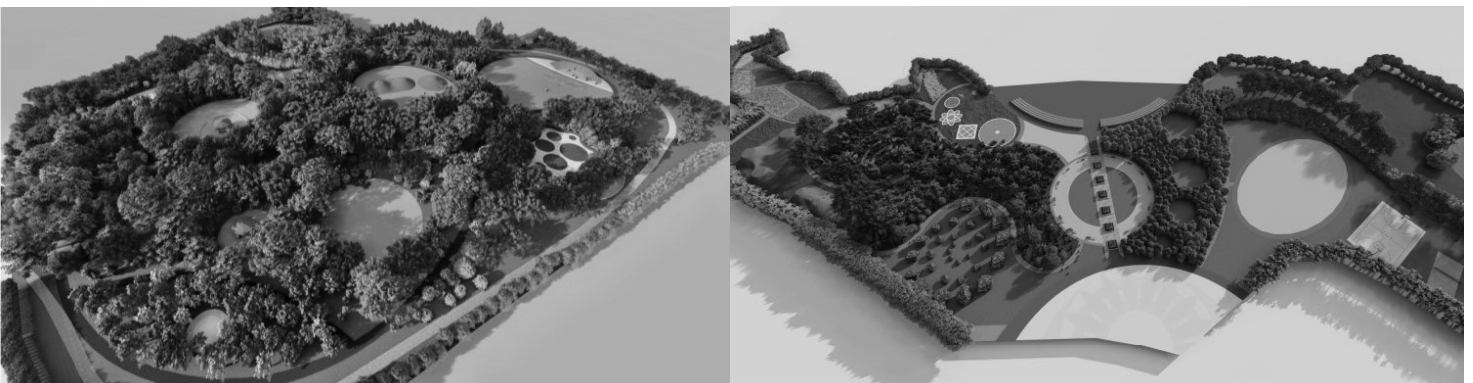

Mangrove Plantation, Conservation & Restoration



Projects

Mangrove Plantation, Conservation & Restoration | *Blue Yatra*

India has 4th largest mangrove area in the world with a long mangrove coastline of about 6,749 km², although in last century India has lost nearly 40 per cent of its mangrove cover. If we let the current trend continue, the coastal areas would become more vulnerable to storms, floods, erosion and cyclones which could potentially ruin millions of lives and livelihood. To counter this, we have come up with sustainable, solution-oriented approach which keeps humanity and mother nature at its core. It is called “Blue Yatra”

Restoring Mangroves: Green Yatra team planting Mangrove saplings (1)



Nature Inspired: Our unique fishbone plantation method

The **Fishbone Channel** method is an innovative mangrove plantation technique that uses biomimicry to restore degraded mangrove forests. The method artificially inundates areas that do not get regular tidal inundation, allowing for the reforestation of **dried-up wetlands** near the intertidal zones.

Benefits of Mangroves



Provides protection to shorelines



Mangrove forests support over 4,000 species of fauna

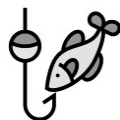

Mangroves provide a variety of resources



Mangroves is a major driving force behind blue economy

*Click on the icon for references

Projects



Restoring Mangroves: Green Yatra team planting Mangrove saplings (2)

In project *Blue Yatra*, we primarily focus upon the Restoration and Conservation of the Coastal ecosystem through Mangrove plantation and through raising awareness about it. Under this project we are working on issues related to conservation of coastal ecosystem extensively in different aspects and sectors across India. We use conventional as well as novel plantation techniques that use biomimicry to create and restore mangrove forests.

This program goes beyond the tree plantation efforts and encompasses a holistic approach towards creating livelihood opportunities and promoting sustainable development.

We have adopted the principles of the Blue Economy concept, integrating it into our practices for long-term environmental and economic benefits.

*‘Mangroves can produce up to **8 times more oxygen** and store up to **4 times more carbon** than tropical forest’*

The techniques are used depending on site conditions for the most ideal outcome. As of 2023, we are delighted to announce that we started our *Blue Yatra* project with **EY Foundation** and **INS Hamla**. Soon we will be covering eastern coast of Orissa as well. We will be soon expanding to other regions as well.

Pedh Lagao



Agroforestry Model: Providing livelihood to farmers



Urban Plantation: Our Miyawaki Plantation in collaboration with ONGC Foundation and NMMC on Palm Beach Road, Navi Mumbai

Projects



Green Haven: A bird's eye view of Nisarg Udyan

Pedh lagao

Trees provide us fresh air and helps reduce the heat island effect in urban areas. Due to rapid urbanization we have seen a sharp increase in deforestation and subsequent rise in air pollution. If we account the expense from delayed logistics and medical expenses caused due to air pollution in India, it comes around ₹ 10.7 lakh crore (\$ 150 billion), or 5.4% of India's GDP annually. Urban citizens are losing lifespan between 5 and 19 years because of air pollution; it is also

responsible for 30% of premature deaths in India.

Our main aim in Pedh Lagao is to revive India's native green cover to support biodiversity and control/prevent ongoing air pollution, heatwave, heat island and climate crisis of respiratory problems to human beings. To increase the green cover in the country, we have started various plantation projects pan India.

Types of Plantations we do:

- **Miyawaki** Urban Plantation
- **Rural** Livelihood Plantation
- **Conventional** Urban Plantation
- **Mass Tree** Plantation

'Urban citizens are losing lifespan because of air pollution. To counter this, we are dedicated to plant 10 crore trees by 2030.'

Projects

Miyawaki Urban Plantation

The Miyawaki Method was invented by Japanese botanist and expert in plant ecology, Dr. Akira Miyawaki. This Method is a unique innovative Potential Natural Vegetation concept, proven to work worldwide, irrespective of soil and climatic conditions. More than 3,000 forests have been successfully created worldwide using this methodology.

In this method, 3-5 saplings are planted per square meter with a minimum of 20-50 different species, creating a multi-layered green forest with no maintenance required after a 2–3-year period.

Urban Greening: 15 month old Miyawaki plantation in Nagagana Park, Belapur



Urban Greening: 12 month old Miyawaki plantation in Ghaziabad, Uttar Pradesh



Till now we have created more than 60 Miyawaki forest pan India in key cities like Mumbai MMR, Delhi NCR, Pune, Bangalore, Aurangabad, Anand, Ayodhya, Nagpur and expanding to more cities as well.

In 2022-23, we have planted more than 5 lakh saplings across Mumbai, Delhi, Pune and Ayodhya partnering with various CSR partners.

‘Miyawaki Urban Plantation make create native dense urban forest in lesser time and space ‘

Benefits of Miyawaki Technique as compared to conventional plantation

30x Better CO₂ reduction

30x Better Noise & Dust Reduction

100x More Biodiversity

30x Denser

10x Faster Growth

100% Native & Organic Forests

Projects

Our Key Projects

Nisarg Udyan

Nisarg Udyan is situated in Koparkhairne, Navi Mumbai. We have planted around 1 lakh sapling using Miyawaki method of plantation in three phases.

For the 4th phase, we have a vision to develop an urban biodiversity park which would include a water body, grassland, tree bank with other amenities. **Sony Music** has been our exclusive partner to implement this ambitious project in Navi Mumbai.

How it looked like: Phase 1 Miyawaki plantation of Nisarg Udyan, Navi Mumbai.



Current Situation: Phase 1 Miyawaki plantation of Nisarg Udyan, Navi Mumbai.



Projects

Hamla Vanam

Our Miyawaki plantation in INS Hamla, Malad is one of the largest Miyawaki Plantation with over 50,000 saplings planted in the site. Our work on the site had started 4 years back and we were able to achieve remarkable results. The

site has underwent complete metamorphosis, blossoming into a flourishing sanctuary of biodiversity. Our partners for this project were **INS Hamla** and our CSR Partner **DCB bank** whose invaluable support has made us achieve this monumental goal.

How it looked like: Miyawaki plantation of INS Hamla, Malad.



Current Situation: Miyawaki plantation of INS Hamla, Malad.



Projects

Jewel of Navi Mumbai

It is one of our most ambitious project. in which we have planted more than 1 lakh 30 thousand saplings. Jewel of Navi Mumbai is the largest Miyawaki plantation done in India. We have carried out extensive landscaping. We incorporated various amenities and infrastructure to make it a place where

the public can connect with nature. Along with plantation, we are carrying out lake restoration which is present inside the park. Our goal is to nurture a park with a calming ambience where the tourists as well as locals could enjoy. This project would not have been possible without **NMMC** and our CSR partners **DCB Bank, Axis Bank, Credit Suisse, Colgate Palmolive, ONGC and Barclays.**

How it looked like: Aerial View of Jewel of Navi Mumbai.



Current Situation: Aerial View of Jewel of Navi Mumbai.



Projects

Hotspot for Urban Biodiversity: Fauna which made our plantation their home.



Indian Roller (*Coracias benghalensis*)



Black Drongo (*Dicurus macrocercus*)



Bar-winged prinia (*Prinia familiaris*)



Golden Jackal (*Canis aureus*)



Indian Garden Lizard (*Calotes versicolor*)



Caterpillar of common castor (*Ariadne merione*)



Indian Cobra (*Naja naja*)



Cucurbit Leaf Beetle (*Aulacophora indica*)



Buff Striped Keelback (*Amphiesma stolatum*)

Projects



Empowering Farmers: Our Livelihood plantation site in Aurangabad, Maharashtra (1)

Rural Livelihood Plantation

Farmers have always been the backbone of our country. They are one of the major stakeholders responsible for maintain the food security of the country. Even though they play one of the most important role in the nation, the conditions of majority of farmers is grim. On an average a farmer in India owns up to 1.08 ha land which is really extremely small as compared to average land held by farmers in USA which is 178 ha. Due to small landholding, most of the farming done is sustenance monoculture farming.

Major issues with monoculture farming is that it degrades the soil over long period of time and replaces native varieties of

crop with the most commercially viable varieties. Another issue related to monoculture farming is that income is annual or biannual according to the crop grown. To mitigate this prevalent problem and reverse the ongoing harmful trend, we have designed Livelihood plantation project which comprise of sustainable farming models for farmers.

Under our Livelihood plantation project, we plant fruit trees and other commercially viable trees to support farmers and increase green cover.

'We plant fruit trees in rural areas to support farmers, boost green cover, and generate livelihood.'

Projects



Empowering Farmers: Our Livelihood plantation site in Aurangabad, Maharashtra (2)

We plant the saplings according to their requirement in their farmland which mostly consist of fruits like Mango, Jackfruit, Guava, etc. We help farmers to shift from single source of income to a stable continuous source of income through planting, free fruit forests, and economically valuable trees along with the crops which they grow. This not only ensures they have multiple sources of steady income, it also makes farmers more resilient to adverse climatic conditions. Capacity building for the farmers are carried out in which we educate and train them in new ways of plantation method and how to take care of them post plantation. Currently our main locations for the Rural Livelihood Plantations project are in Wada (Palghar), Aurangabad.

Benefits of Rural Livelihood Plantation

- | | | |
|----------------------|---|---|
| Environmental Impact |  | Sequester CO ₂ & Other GHG gases |
| |  | Improve Land Quality |
| |  | Increase Climate Resilience |
| Economic Impact |  | Provide an Extra Source of Income |
| |  | Improve Community Health |
| |  | Improve Food Security |



Sustainable Income: Produce obtained from our livelihood plantation

Projects

Conventional Urban Plantation

We use conventional plantation to increase green cover in urban areas. In this method, we plant the saplings, which have distance between them 8-10 ft.

We have carried out Conventional Urban Plantation in Mumbai, Delhi, etc. It is done where land is available in large area. We, usually carryout Conventional Plantation on the onset of monsoon when the land is ready for the sowing of the saplings.

'We plant indigenous species to restore biodiversity and create healthy, pollution-free urban spaces.'

Benefits of Conventional Urban Plantation



Increases urban green cover



Acts as a carbon sink for urban areas



Helps to reduce pollution

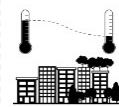

Reduces urban heat island effect

Conventional Plantation: Volunteers participating in conventional plantation





Water Body Restoration

Projects



Before

How it was: Chauganpur Pond before restoration, Greater Noida.

Water Body Restoration | *Project Jal*

Water is important resource for majority of the life forms on Earth. No one can think of life without water. We are witnessing that water level in various part of the country is declining.

India's mega cities are running out of water. Villages are the only source, but this comes at a cost to rural populations. Global warming, over exploitation, and human error are leading to a **Day Zero** scenario. We rejuvenate existing water bodies (lake, pond, river) and create new ones.

As of now our team of experts have rejuvenated 25+ lakes and ponds in Mumbai, Delhi NCR and Bangalore.

By restoring the degraded water body, we are able to provide clean water for livestock to drink water, habitat for the aquatic life and clean space for the people to spend their leisure time.

Condition before intervention

- The lake was covered with water hyacinth.
- There was thick layer of silt formed
- Presence of untreated waste found

Projects



Current Situation: Chauganpur Pond after restoration, Greater Noida.

*'We aim to rejuvenate & restore water bodies to avoid the **DAY ZERO** situation in Indian mega cities'*

We use different methods such as creating small check dams, LBS, CCT, wells, ponds, soak pits, trenches and artificial water bodies to tap rain and stream water.

These create opportunity for community engagement activities, revival of biodiversity, and area where people can destress themselves.

Impact Seen

- By desilting we increase the water holding capacity of the lake and helps to control flood
- It enhances the recreational opportunities
- Improves the water quality of the area
- Protecting the aqua water life



Waterbody Restoration : Binjipura Lake after restoration, Bangalore

Carbon Auditing



Projects

Carbon Auditing

We are committed to helping corporations reduce their carbon footprint and mitigate their impact on climate change. One of the ways we do this is by conducting carbon audits.

A carbon audit is a systematic process for measuring and quantifying the greenhouse gas (GHG) emissions of an organization. It involves identifying all of the sources of GHG emissions, from direct emissions (such as those from on-site combustion of fossil fuels) to indirect emissions (such as those from the electricity grid and transportation of goods and materials).

Once the audit is complete, we work with the corporation to develop a plan to reduce its emissions. This may involve a variety of measures, such as improving energy efficiency, switching to renewable energy sources, and reducing waste. We believe that carbon audits are an essential tool for corporations that are serious about reducing their environmental impact. We are committed to helping corporations on this journey and to making a positive impact on climate change.

The carbon auditing that was carried out for **INS Hamla** showed their emission levels to be **4797.7 mt CO₂e**. Through adopting carbon reduction strategies along with trees plantation suggested by us, INS Hamla was able to offset **846 mt CO₂e**. Not only did they transformed their organization structure into a more sustainable one, they also won the Green practice award among all the navy campuses. We also carried carbon auditing for two units of **Lloyd** where their consolidated emissions were found out to be **878.87 mt CO₂e**. We suggested carbon mitigation strategies along with plantation of 16,465 trees to offset 448 mt CO₂e from their current level.

'Through carbon auditing, organizations can become more efficient, reduce their excess expenditure and be more eco friendly'

Benefits of Carbon Auditing

Identify and reduce Greenhouse Gas Emissions



Improve sustainability performance



Improve brand reputation



Support climate action



World Environment Day: Our team with INS Hamla personnel

Climate Education



Projects

Climate Education

Climate change is already having a significant impact on people and ecosystems around the world, and these impacts are only expected to worsen in the coming decades. Through our climate education program, we are determined to bring a change in the perspectives of people on how they view nature and instil climate sensitivity in them. In our climate education session, we incorporate a wide array of sustainability-oriented workshops and activities which can be delivered in both online and offline medium. The complexity of these sessions are specifically designed according to the target audience. The workshops and activities for a climate education session can be customized as per the client's liking.

'Main goal of climate education is to raise awareness of climate change and motivate people to work towards mending it.'



Corporate Session: An offline session conducted for **Nexthink** India, Bangalore



Academic Sessions: Climate education sessions conducted for Students.

Benefits of Climate Education



Increase people's understanding about Climate Change



Increase Government & Corporate accountability



Encourage environment positive attitude & behaviour change.



Teaches about CO₂ emissions & ways to reduce it

Green Campus



Projects



Road to Sustainability: Our team with Zila Parishad School Nimbavali, Wada.

Green Campus

One of the major factors of whether an initiative launched by the Government becomes a success or failure is the willingness of public to abide and maintain the initiative. Accountability among the public is rooted in the values and principles that they acquire during their childhood days. Schools and colleges play a vital role in molding the minds of the young children and how they act or behave as adults.

By keeping this very sentiment in mind, India has taken a number of initiatives to make its schools and colleges green, including the Green Schools Programme, the Sustainable Campus Framework, the Green Colleges Initiative, etc.

But here is still more work to be done. To aid and empower these initiative, we have created Green Campus program

Benefits of Green Campus



Creating climate awareness among future generations



Equip students with skills that promotes sustainability



Developing sustainable infrastructure



Improves students' leadership & communication aptitude

Projects

'The linked global concerns we face, such as climate change, environmental degradation, and loss of diversity, as well as its social ramifications, can be addressed by Education by equipping learners of all ages with the knowledge, skills, and attitudes necessary'

Our Green Campus Programme's core objective is to inspire students to move beyond theories and textbooks and concentrates on real world application. The programme is directed to sensitize students toward fellow inhabitants of our planet and to the environment through hands-on and thought-provoking activities. Furthermore, we help schools and colleges to transform their campus into a more environment friendly one. We integrate sustainable practices and infrastructure in the campus premise to make it more energy and water efficient which drastically reduce their expenses.

Schools that we adopted under Green Campus programme in Vada, Maharashtra is the most recent addition to our transformative work. We have conducted a wide array of activities, provided eco friendly inventory and are currently working on making the schools more environment friendly and sustainable. We collect feedback and opinions from both students and faculties on the progress that we have did under Green Campus Programme.



Climate education: Our director conducting a session on environment.

We also carry out periodic monitoring and impact evaluation of our work so that we can take necessary steps to make our project more effective.

Areas of Focus



Infrastructure



Activities



DIY

Cause Related Marketing



Projects



Together for a better future: Our volunteers carrying out plantation

Cause Related Marketing

In CRM, a corporation forms a mutually beneficial partnership with a non-profit organization to promote a shared cause. In exchange for donation to the non-profit company. This can improve its brand awareness, customer loyalty and sales.

We carry out various CSR activities for the benefit of public. We incorporate a wide array of causes which make a meaningful impact over the society as well as the stakeholders involved in our projects, like planting trees, installing sources of renewable energy and other. Yet they remain unaware of various environmental and social issues. So, we make public also one of our stakeholder with the corporation, in which their contribution goes towards the fulfillment of the social or green cause. Another perspective we can have is that there are times when projects which are designed to achieve a social cause remains unfull-

'CRM helps to make a positive brand image & customer loyalty while achieving your business objectives.'

-filled due to insufficient funds. Through CRM, we can bridge that gap through public support and achieve the purpose of the project.

This also influences the brand image of the company in a positive way and builds brand loyalty among its consumers.

Benefits of CRM



Helps to spread awareness among public.



It encourages people to adopt sustainable lifestyle



It helps to align interests of the public with the project



It aids the corporations to brand their product to a noble cause

Financials

Green Yatra Trust
Registration No: E-6392 (Thane)
Balance Sheet as of 31st March 2023

	Particulars	Schedule Nos.	As of 31 st March 2023	As of 31 st March 2022
I	<u>Sources of Funds</u>			
1	NPO Fund			
(a)	Corpus Fund	2	55,511	55,511
(b)	Reserves & Surplus	3	2,72,99,914	1,66,33,622
2	Current Liabilities			
(a)	Trade Payables	4	5,00,92,545	2,65,24,380
(b)	Other Current Liabilities	5	1,82,545	3,37,779
	TOTAL		7,76,30,515	4,35,51,292
II	ASSETS			
1	Non-current assets			
(a)	Property, Plant and Equipment and Intangible assets			
	i) Property, Plant and Equipment	6	1,71,489	2,22,057
2	Current Assets			
(a)	Cash and Bank Balances	7	7,67,31,262	4,31,28,586
(b)	Other Current Assets	8	7,27,764	1,99,748
	TOTAL		7,76,30,515	4,35,51,292

Financials

Green Yatra Trust
Registration No: E-6392 (Thane)
**Income and Expenditure Account for the Period
ending 31st March 2023**

	Particulars	Schedule Nos.	As of 31 st March 2023	As of 31 st March 2022
	<u>INCOME</u>			
I	Donation & Grants	9	17,47,51,193	12,97,83,524
II	Other Income	10	17,04,859	8,37,382
III	Total Income (I+II)		17,64,56,052	13,06,20,906
IV	APPLICATION OF INCOME			
(a)	Project Plantation Expenses	11	16,42,73,484	12,89,08,878
(b)	Finance costs	12	9,723	32,593
(c)	Depreciation on Fixed Assets	6	79,066	39,349
(d)	Other Expenses	13	14,27,487	5,39,146
	Total Expenses		16,57,89,760	12,95,19,966
V	Expenses of Income or Expenditure for the year (III-IV)		1,06,66,292	11,00,941
VI	Tax Expenses			
(a)	Current Tax		-	-
VII	Appropriations Transfer from Funds Balance transferred to General Funds (V+VI)		1,06,66,292	11,00,941
	Appropriations Transfer from Funds Balance transferred to General Funds		1,06,66,292	11,00,941

Our Key Partners

We have been associated and working with 500+ fortune and other prestigious companies, Government bodies, Reputed colleges, universities, 1000s of schools across India.



And many more counting...

नवराष्ट्र

शहरीतील प्रदूषण सुधारण्यासाठी आयुक्तांचा नि नवी मुंबईत १० मियावाकी

विदर्भ प्रमाण | नवराष्ट्र

निसर्ग उद्यानात मियावाकी प्रकल्प

१० एकरावर उभारणी

४०,००० देशी झाडांची लागवड

नवी मुंबई : नवी मुंबई महापालिका आयुक्त अभिजित बांगर हे शहरीतील वातावरण सुधारण्यासाठी प्रयत्नशील आहेत. नवी मुंबई शहरासाठी यंदा सादर केलेल्या अर्थसंकल्पात शिक्षण व आरोग्यसेवा पत्रव्यवहारा देखील प्राधान्य देण्यात आले आहे. नवी मुंबई शहराला रियावाजीया शहरात देशात सहावा क्रमांक मिळाला आहे. आधुनिक शहर म्हणूनच नवी मुंबईला प्रदूषणानेदेखील धोकादायक पातळी ओलांडल्याचे पत्रव्यवहार अहवालानेचून अनेकदा दिसून आले आहे. त्यामुळे आयुक्त बांगर यांनी पत्रव्यवहार सुधारण्याकडे प्राधान्य दिले असून त्यानुसार शहरात १० मियावाकी प्रकल्प उभारण्यात येणार आहेत. त्यातील नवी मुंबईतील पहिला ४० हजार वृक्ष लागवड केलेला पहिला मियावाकी प्रकल्प साकारला गेला आहे. उर्वरित नऊ ठिकाणे निश्चित करण्यात आली आहेत.



देशी झाडांमुळे जैवविविधतेत मदत

शहरात विकासासाठी अनेक पुढाची काल केली जात असतानाच आयुक्त बांगर हे स्वच्छतेसाठी पर्यावरणात नवे बदल घडवून आणण्यासाठी आग्रही आहेत. त्यानुसार मियावाकी प्रकल्प आकारास आणत आहे. मूळ जागीची पद्धतीचा धरून असून जागभरात या कल्पनेला विविध देशांनी उलटून घेतले आहे. सध्या देशभरात विविध ठिकाणी मियावाकी प्रकल्प उभारलेल्या प्रोग्रामा या खात्रीची संशोधनेतून हे प्रकल्प उपभोग जात आहेत. नवी मुंबईत सोनी म्युझिक कॉम्प्लेक्स सायंसआर फंडातून कोरवडेपौलिस निर्मा प्रकल्प येथे तब्बल १०० एकरावर हा प्रकल्प उभारला गेला आहे. हिंसेरमधेचा प्रकल्पदेवे काम सुरू करण्यात आले होते. त्यानंतर नवी मुंबईच्या हे काम पूर्ण करण्यात आले. पुढील दोन वर्षे झाडांची निरामणी राखावी लागणार असून त्यानंतर या उद्यानात काळजी घ्यावी लागणार नाही, असे प्रोग्राम यात्रा संशोधने प्रदीप पिचारी यांनी सांगितले. मुख्य म्हणजे ही सर्व झाडे देशी जातीची असल्याने तब्बल पुढील शेकडो वर्षे ही झाडे जगतात. तसेच

आपले दुर्दैव आहे की, आपल्या शहरांमध्ये विदेशी प्रजातीची झाडे कामय लागली जातात. तेन टी, फुरमोहर यासारखे अनेक झाडे ही विदेशी आहेत. अशा झाडांवर पक्षी, किटक, फुलपाखरे अविवास करत नाहीत. शहरातून अनेक पक्षी जसे, की हिमयात्रा लून होत आहेत. याचे कारण मोंबाईल लहरीसारखे विदेशी वृक्ष हे देखील आहेत. मियावाकी प्रकल्प करताना देशी वृक्ष व जमिनीचा पौत सुधारण्याकडे आग्रही लक्ष देतो. सध्या नवी मुंबईतील रोपे ही काही फूट वाढली आहेत. येत्या काळात ती १५ ते २० फूट वाढतील. सध्या संस्थेचे कामगार देखभाल करत आहेत. त्यानंतर मात्र नैसर्गिकरित्या हे वृक्ष वाढून बहरतील. पक्ष्यांचा अविवास वाढेल.

कसे आकारास आले

कोपरवळीचे येथील निसर्ग उद्यानात असलेला १०० एकरावर त्यासाठी निश्चित करण्यात आला. ठिकाण निश्चित केल्यावर मातीची रासायनिक, जैविक आणि भौतिक अशी शारशुद्धत पद्धतीवर तपासणी करण्यात आली आहे. माती योग्य असल्याचे उद्घाटन आल्यावर खडे खणण्यात आले. खडे खणताना खोलवर गेल्यावर कोंक्रीट, सिमेंट, डेब्रिज, प्लास्टिक हाती लागले. ते काढण्यावर त्या ठिकाणी पुन्हा माती टाळण्यात आली. मातीचा तट सुधारण्यासाठी व रोपांची वाढ होण्यासाठी नैसर्गिक खडे वापरण्यात आली. गावीच्या शेणापासून तयार केलेले खत वापरतानादेखील जसा गावीयेथी देशी गावीच्या शेणखतांना प्राधान्य दिले गेले आहे. एकूण ४० हजार रोपे लागवड्यात आली. त्यास काढ्यांचा आधार देण्यात आला. मियावाकी प्रकल्पाची खासियत म्हणजे

निसर्ग उद्यानात मियावाकी प्रकल्प साकारण्यात आला आहे. यासाठीच नवी मुंबईत जेतून ओढ नवी मुंबईस नऊ ठिकाणी निश्चित करण्यात आली आहेत. जवळपास ४० एकरावर झाडे लागू शकतो, यासह तिसरा प्रकल्प एक टोन फिरोलॉजीट रकबाच्या काडेला असलेला भागात करण्यात आला आहे. त्यासह वाहतूक व उद्यानामध्ये मियावाकी तयार करण्यात येणार आहेत. शहराचे वातावरण सुधारण्यास आणि जैवविविधता वाढण्यास मदत होईल.

अभिजित बांगर, आयुक्त, नवी मुंबई

नवराष्ट्र

नवी मुंबईत मियावाकी नंदनवन; प्रदूषण सुधारण्यासाठी मदत, ४० ते ५० कोटीची बचत १६ महिन्यांत रुजवले तीन लाख वृक्ष



विदर्भ प्रमाण | नवराष्ट्र
नवी मुंबई: नवी मुंबईत निसर्ग उद्यानात असलेला १०० एकरावर त्यासाठी निश्चित करण्यात आला. ठिकाण निश्चित केल्यावर मातीची रासायनिक, जैविक आणि भौतिक अशी शारशुद्धत पद्धतीवर तपासणी करण्यात आली आहे. माती योग्य असल्याचे उद्घाटन आल्यावर खडे खणण्यात आले. खडे खणताना खोलवर गेल्यावर कोंक्रीट, सिमेंट, डेब्रिज, प्लास्टिक हाती लागले. ते काढण्यावर त्या ठिकाणी पुन्हा माती टाळण्यात आली. मातीचा तट सुधारण्यासाठी व रोपांची वाढ होण्यासाठी नैसर्गिक खडे वापरण्यात आली. गावीच्या शेणापासून तयार केलेले खत वापरतानादेखील जसा गावीयेथी देशी गावीच्या शेणखतांना प्राधान्य दिले गेले आहे. एकूण ४० हजार रोपे लागवड्यात आली. त्यास काढ्यांचा आधार देण्यात आला. मियावाकी प्रकल्पाची खासियत म्हणजे

कसे आकारास आले मियावाकी उद्यान ?
ठिकाण निश्चित केल्यावर मातीची रासायनिक, जैविक आणि भौतिक अशी शारशुद्धत पद्धतीवर तपासणी करण्यात आली आहे. माती योग्य असल्याचे उद्घाटन आल्यावर खडे खणण्यात आले. खडे खणताना खोलवर गेल्यावर कोंक्रीट, सिमेंट, डेब्रिज, प्लास्टिक हाती लागले. ते काढण्यावर त्या ठिकाणी पुन्हा माती टाळण्यात आली. मातीचा तट सुधारण्यासाठी व रोपांची वाढ होण्यासाठी नैसर्गिक खडे वापरण्यात आली. गावीच्या शेणापासून तयार केलेले खत वापरतानादेखील जसा गावीयेथी देशी गावीच्या शेणखतांना प्राधान्य दिले गेले आहे. एकूण ४० हजार रोपे लागवड्यात आली. त्यास काढ्यांचा आधार देण्यात आला. मियावाकी प्रकल्पाची खासियत म्हणजे

कोटे, किती झाडे

मिर्जापूर	१० हजार
कोरवडे	१० हजार
कोरवडे	१० हजार
कोरवडे	१० हजार
कोरवडे	१० हजार
कोरवडे	१० हजार
कोरवडे	१० हजार
कोरवडे	१० हजार
कोरवडे	१० हजार
कोरवडे	१० हजार

मोरचे धरणाच्या परिसर मियावाकीसाठी उपाययोजना
मोरचे धरणाच्या परिसर मियावाकीसाठी उपाययोजना करण्यात आली आहे. यासाठीच नवी मुंबईत जेतून ओढ नवी मुंबईस नऊ ठिकाणी निश्चित करण्यात आली आहेत. जवळपास ४० एकरावर झाडे लागू शकतो, यासह तिसरा प्रकल्प एक टोन फिरोलॉजीट रकबाच्या काडेला असलेला भागात करण्यात आला आहे. त्यासह वाहतूक व उद्यानामध्ये मियावाकी तयार करण्यात येणार आहेत. शहराचे वातावरण सुधारण्यास आणि जैवविविधता वाढण्यास मदत होईल.

शहरीतील प्रदूषणमुक्तीसाठी होणार मदत

नवी मुंबईत तीन लाख झाडांचे उद्दिष्ट



विदर्भ प्रमाण | नवराष्ट्र
नवी मुंबई: नवी मुंबईत निसर्ग उद्यानात असलेला १०० एकरावर त्यासाठी निश्चित करण्यात आला. ठिकाण निश्चित केल्यावर मातीची रासायनिक, जैविक आणि भौतिक अशी शारशुद्धत पद्धतीवर तपासणी करण्यात आली आहे. माती योग्य असल्याचे उद्घाटन आल्यावर खडे खणण्यात आले. खडे खणताना खोलवर गेल्यावर कोंक्रीट, सिमेंट, डेब्रिज, प्लास्टिक हाती लागले. ते काढण्यावर त्या ठिकाणी पुन्हा माती टाळण्यात आली. मातीचा तट सुधारण्यासाठी व रोपांची वाढ होण्यासाठी नैसर्गिक खडे वापरण्यात आली. गावीच्या शेणापासून तयार केलेले खत वापरतानादेखील जसा गावीयेथी देशी गावीच्या शेणखतांना प्राधान्य दिले गेले आहे. एकूण ४० हजार रोपे लागवड्यात आली. त्यास काढ्यांचा आधार देण्यात आला. मियावाकी प्रकल्पाची खासियत म्हणजे

२५ ते ३० कोटी उपाययोजना बचत
नवी मुंबईत निसर्ग उद्यानात असलेला १०० एकरावर त्यासाठी निश्चित करण्यात आला. ठिकाण निश्चित केल्यावर मातीची रासायनिक, जैविक आणि भौतिक अशी शारशुद्धत पद्धतीवर तपासणी करण्यात आली आहे. माती योग्य असल्याचे उद्घाटन आल्यावर खडे खणण्यात आले. खडे खणताना खोलवर गेल्यावर कोंक्रीट, सिमेंट, डेब्रिज, प्लास्टिक हाती लागले. ते काढण्यावर त्या ठिकाणी पुन्हा माती टाळण्यात आली. मातीचा तट सुधारण्यासाठी व रोपांची वाढ होण्यासाठी नैसर्गिक खडे वापरण्यात आली. गावीच्या शेणापासून तयार केलेले खत वापरतानादेखील जसा गावीयेथी देशी गावीच्या शेणखतांना प्राधान्य दिले गेले आहे. एकूण ४० हजार रोपे लागवड्यात आली. त्यास काढ्यांचा आधार देण्यात आला. मियावाकी प्रकल्पाची खासियत म्हणजे

- १. ठिकाण निश्चित केल्यावर मातीची रासायनिक, जैविक आणि भौतिक अशी शारशुद्धत पद्धतीवर तपासणी करण्यात आली आहे.
- २. माती योग्य असल्याचे उद्घाटन आल्यावर खडे खणण्यात आले.
- ३. खडे खणताना खोलवर गेल्यावर कोंक्रीट, सिमेंट, डेब्रिज, प्लास्टिक हाती लागले. ते काढण्यावर त्या ठिकाणी पुन्हा माती टाळण्यात आली.
- ४. मातीचा तट सुधारण्यासाठी व रोपांची वाढ होण्यासाठी नैसर्गिक खडे वापरण्यात आली.
- ५. गावीच्या शेणापासून तयार केलेले खत वापरतानादेखील जसा गावीयेथी देशी गावीच्या शेणखतांना प्राधान्य दिले गेले आहे.
- ६. एकूण ४० हजार रोपे लागवड्यात आली.
- ७. त्यास काढ्यांचा आधार देण्यात आला.
- ८. मियावाकी प्रकल्पाची खासियत म्हणजे

Miyawaki tech to help develop urban forests in 2,200 sqm land in east Delhi

Vibha.Sharma@timesgroup.com
New Delhi: East Delhi Municipal Corporation (EDMC) has launched an ecosystem restoration initiative with the help of an NGO Green Yatra. The civic body is planning to develop urban forests on vacant land space using Miyawaki technology. EDMC has identified a 2,200 sqm vacant land parcel at Ghazipur village near Mayur Vihar Phase III, where 7,000 saplings were planted on Wednesday. The Miyawaki method, also called the pot seedling method, is an afforestation technique that uses native plant species along with canopy layer. After treating the soil, the NGO has dug the land ar...

Hindustan Times MY MUMBAI

2,500-sqm Miyawaki forest ready in Malad in 9 months

Miyawaki forests across Mumbai
Status of plantations in the city
Aside from BMC's efforts, five major plantations across the Mumbai Metropolitan Region (MMR) have been completed by Green Yatra. Central Railside Warehouse Company Ltd, Jogheshwari | Bhandup Complex | State Reserve Police Force Premises in Talaja, Navi Mumbai | Ambernath | HNS Hamla | 2,500 sqm

Miyawaki Way: Urban forest blooms in Bhayandar



SURESH GOLANI
suresh.golani@fpj.co.in
In support of the Mira Bhayandar Municipal Corporation's (MBMC) ambitious goal of increasing the green cover of the twin-city, volunteers attached to NGO Green Yatra have teamed up with Sony Music India to transform a barren land in Bhayandar East into an urban forest. Notably, it's being created through Miyawaki, a unique forestation technique based on the work of Japanese botanist Akira Miyawaki. The Miyawaki-style urban forest was inaugurated on Saturday by MBMC Mayor Jyotsna Hasnale in the presence of deputy mayor Has-mukh Gehlot, municipal commissioner Dilip Dhole, standing committee chairman Rakesh Shah, members of Green Yatra and representatives from Sony Music India. Half portion of the two-acre reserved land has been utilised to plant 10,000 saplings of various species through the Japanese technique, which has the biggest advantage of fast growing trees on small plots of land and turning them into tiny but more biodiverse and dense forests. Deputy municipal commissioner Sanjay Shinde said, "The first of its kind initiatives for the civic body, the urban forest will not only reduce pollution but also act as the much needed green lung. The NGO will maintain and nurture the plantations until they grow up and the land takes the shape of a tiny but dense forest." The plot of land was crying for attention when the civic administration decided to rope in the NGO to change its face in collaboration with the music company under its corporate social responsibility initiative. The MBMC is also keen to take steps to attract birds to it.

Awards

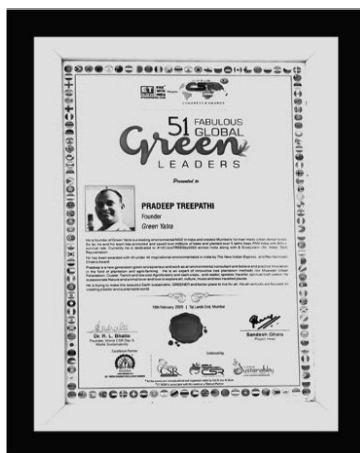
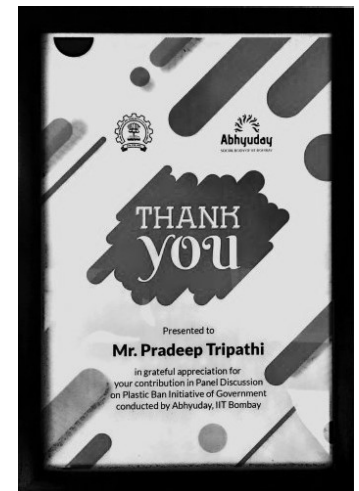
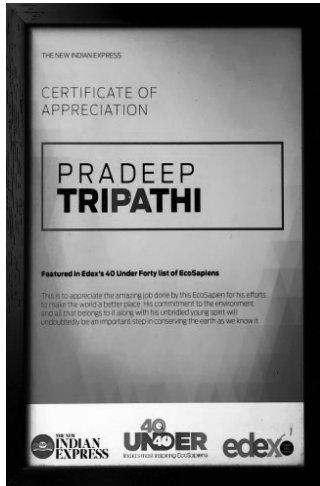



Eco Star, Vishveshwar Nagar Rd, Churi
Wadi, Goregaon, Mumbai, Maharashtra
40006
Phone- 099675 38049
Email- info@greenyatra.org

For further
information, please
visit our
website at
www.greenyatra.org

